

Polaris Slingshot LED headlights for USA/Canada version

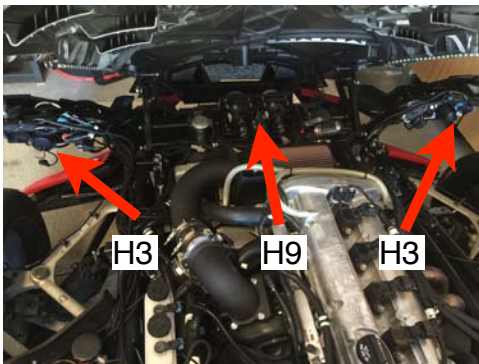

Outboard light(s) uses H3 bulb. Center uses H9. Please note special base used for H3.

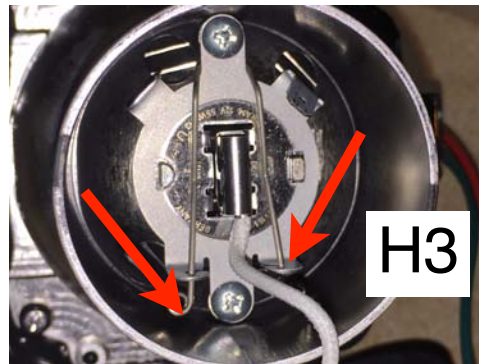

Using a long nose plier, undo the metal clip that holds the factory H3 bulb and remove.



You will use the black base on the headlight then twist the LED to install.



Remove black plastic base. Note the bottom has base lip. This flat base will go into the base of the headlight.



Position the plastic base on the light housing. Make sure it sits flat. There is metal tab on top and bottom and it fits only one way. Once the base sits flat, place the metal clip around the base and re-hook on the metal base. Pull the black wire from the ground base of the light (See red arrow above). You will attach this to the black ground on the LED driver. Take your led and line up the side pins and insert into the housing. Once seated flat twist clockwise and lock into place.

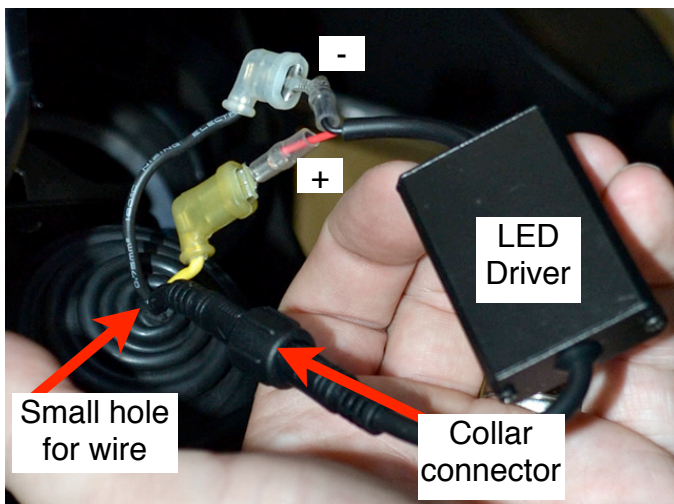

Make a small opening in the center of the black rubber boot as shown above. Pull the yellow and (black wire off of the light housing) and the harness wire from LED light through the outside of the boot. Connect the LED driver to the LED harness. Use Di-electric grease and coat all electrical connection to ensure no corrosion or voltage leak in the future. Line up the pin as you connect the harness together and tighten the waterproof collar. Connect the LED driver wire to the factory harness. Red to yellow, black to black. If the spade is loose simply crimp and re-insert Use Di-electric grease on all connections.